



Flat 2, 9 The Esplanade, Burnham-On-Sea TA8 1BE

£650 PCM



1 Bedroom Flat - Town Centre Location, Sea Front

- DEPOSIT £750
- LOUNGE/KITCHEN
- SHOWER ROOM
- HOLDING DEPOSIT £150
- DOUBLE GLAZING
- NO PARKING
- GOOD SIZED BEDROOM
- ELECTRIC HEATING
- SEAFRONT POSITION



ABBOTT & FROST SALES • LETTINGS • COMMERCIAL

EST. 1949 18 College St, Burnham-on-Sea TA8 1AE • lettings@abbottandfrost.co.uk • 01278 782266 • www.abbottandfrost.co.uk

A 1 BEDROOM 1ST FLOOR FLAT WITH ELECTRIC HEATING 'TO LET' ON THE SEAFRONT

DEPOSIT: £750 Payable prior to occupation.

ACCOMMODATION: The Accommodation has been subject to redecoration work, some new carpet/flooring and briefly comprises; Entrance Lobby, Bedroom with built in storage cupboard, Shower Room and Lounge/Kitchen. The property benefits from Double Glazing and Electric Heating.

OUTGOINGS: The tenants will be responsible for all outgoing. Somerset (Sedgemoor District) Council Tax Band: A £1,713.49 - 2026/27

TENANCY: An Assured Periodic Tenancy.

TENANT COSTS: Please refer to our website for our Tenant Fee Structure. Holding Deposit (£150 per tenancy) - One weeks rent. This is to reserve a property. Please Note: This will be withheld if any relevant person (including any guarantor(s)) withdraw from the tenancy, fail a Right-to-Rent check, provide materially significant false or misleading information, or fail to sign their tenancy agreement (and / or Deed of Guarantee) within 15 days (or other Deadline for Agreement as mutually agreed in writing).

MATERIAL INFORMATION: The property has the benefit of Mains Electric, Water and Drainage.

For an indication of specific speeds and supply or coverage in the area, we recommend interested parties use:-

<https://checker.ofcom.org.uk/en-gb/mobile-coverage>

<https://checker.ofcom.org.uk/en-gb/broadband-coverage>

CONDITIONS: Income of £19,500 minimum required. Non Smokers

AVAILABILITY: May 2026

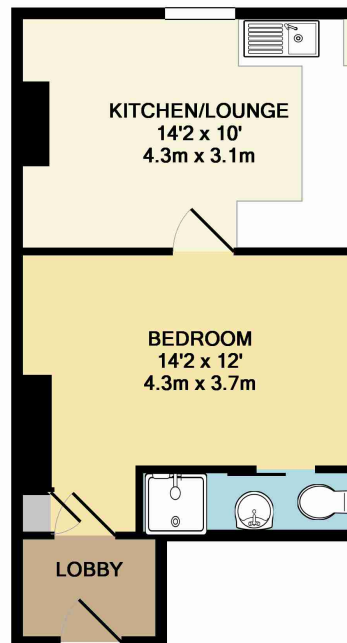

Whilst every attempt has been made to ensure the accuracy of the floor plan contained here, measurements of doors, windows, rooms and any other items are approximate and no responsibility is taken for any error, omission, or mis-statement. This plan is for illustrative purposes only and should be used as such by any prospective purchaser. The services, systems and appliances shown have not been tested and no guarantee as to their operability or efficiency can be given
Made with Metropix ©2009

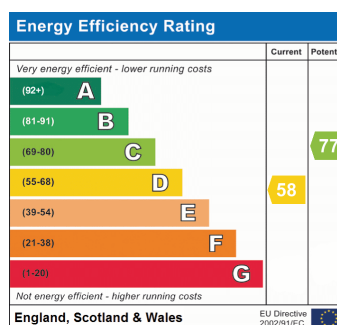

CONSUMER PROTECTION FROM UNFAIR TRADING REGULATIONS

These details are for guidance only and complete accuracy cannot be guaranteed. If there is any point, which is of particular importance, verification should be obtained. They do not constitute a contract or part of a contract. All measurements are approximate. No guarantees can be given with respect to planning permission or fitness of purpose. No apparatus, equipment, fixture or fitting has been tested. Items shown in photographs are NOT necessarily included. Interested parties are advised to check availability and make an appointment to view before travelling to see a property.

THE DATA PROTECTION ACT 1998

Please note that all personal provided by customers wishing to receive information and/or services from the estate agent will be processed by the estate agent. For further information about the Consumer Protection from Unfair Trading Regulations 2008 see <http://www.legislation.gov.uk/uksi/2008/12277/contents/made>